

Electrocardiography





AAMI COLOR CODING

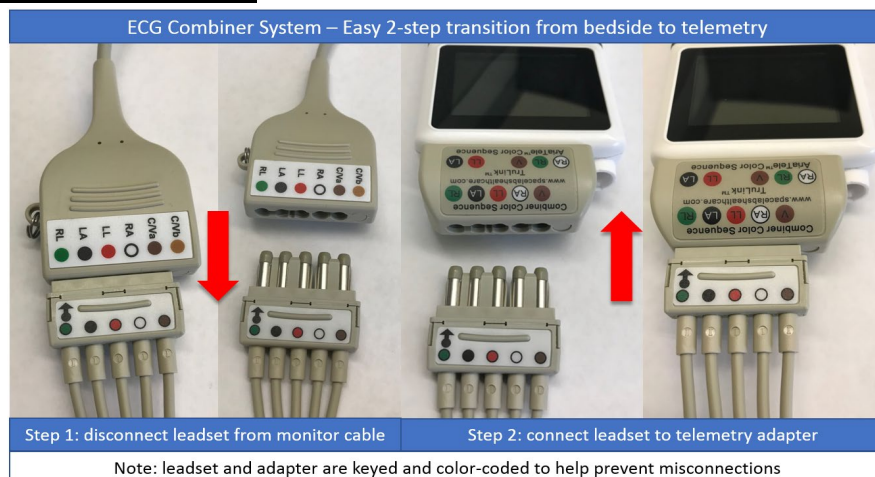

ECG Combiner Lead Wires & Cables

Our ECG Combiner System features a quick-yoke connection between cables and lead wires which allows a quickly connect/disconnect between monitors and telemetry. System is validated for use with Spacelabs command modules 90496/91496 and Aria/Ultraview Telemetry.



	Order Code	Description	Length	Qty
ECG Combiner Lead Wire Sets - requires ECG Combiner Cable or Adapter				
	Disposable, DIN Shielded, Pinch, AAMI			
	700-0006-50	3-Lead	Pinch	127cm /50 in 25 Sets
	* 700-0006-32	5 Lead	Pinch	127cm /50 in 25 Sets
	* 700-0006-33	5 Lead (V-Lead)	Pinch	127cm /50 in 25 Sets
	Disposable, DIN Shielded, Snap, AAMI			
	700-0006-61	5 Lead	Snap	127cm /50 in 25 Sets
	Reusable, DIN Shielded, Pinch, AAMI			
	* 700-0006-35	3 Lead	Pinch	74cm /29 in 1 Set
	* 700-0006-37	5 Lead	Pinch	74cm /29 in 1 Set
	* 700-0006-38	5 Lead (V-Lead)	Pinch	74cm /29 in 1 Set
	700-0010-00	3 Lead	Pinch	130cm/51 in 1 Set
	* 700-0010-01	5 Lead	Pinch	130cm/51 in 1 Set
	700-0010-02	5 Lead (V-Lead)	Pinch	130cm/51 in 1 Set
	Reusable, DIN Shielded, Snap, AAMI			
	* 700-0007-35	3 Lead	Snap	74cm /29 in 1 Set
	* 700-0007-37	5 Lead	Snap	74cm /29 in 1 Set
* Product not available for sale into CE Mark Countries (EU)				

ECG Combiner Lead Wires & Cables

Our ECG Combiner System features a quick-yoke connection between cables and lead wires which allows a quickly connect/disconnect between monitors and telemetry. System is validated for use with Spacelabs command modules 90496/91496 and Aria/Ultraview Telemetry.

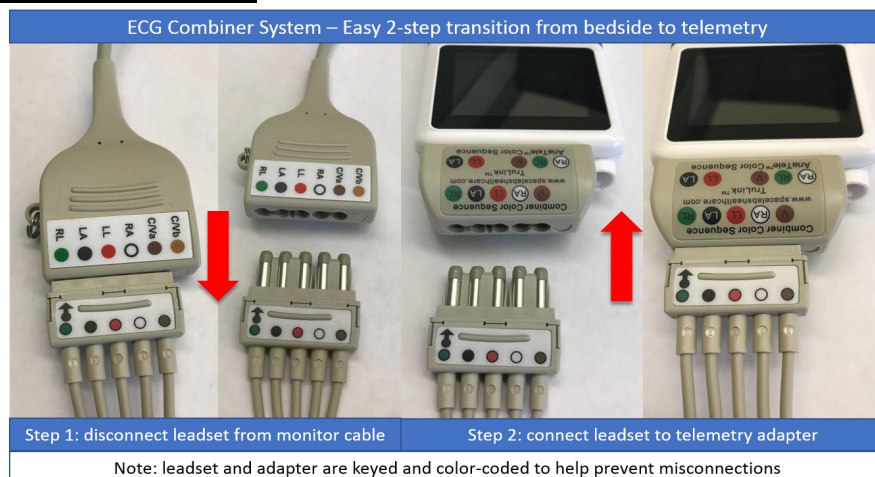

Order Code	Description	Length	Qty
------------	-------------	--------	-----

ECG Combiner Cables



Spacelabs Connect Hardwired Cables for use with Spacelabs command module 90496/91496

* 700-0008-55	3 Lead	Spacelabs	305 cm/10 ft	1 Cable
* 700-0008-57	5 Lead	Spacelabs	305 cm/10 ft	1 Cable
700-0008-32	5 Lead	Spacelabs	457 cm/15 ft	1 Cable
* 700-1008-56	10 Lead (5+5)	Spacelabs	305 cm/10 ft	1 Cable
* Product not available for sale into CE Mark Countries (EU)				

ECG Combiner Adapters



Spacelabs Telemetry, AAMI

700-0008-80	5 Lead	Ultraview Telemetry (9034X/ 9134X)	1 Adapter
700-0008-88	5 Lead	Aria Telemetry (96281)	1 Adapter

ECG Combiner Cables for Standardization



Other manufacturers

700-0008-37	5 Lead	GE	305 cm/10 ft	1 Cable
700-0008-49	5 Lead	Philips	305 cm/10 ft	1 Cable

Indicates discontinued part, available while supplies last

ECG Lead Wire & Cables - Shielded

TruLink ECG lead wires are designed and validated for use with Spacelabs monitoring systems. Ten foot reusable monitor cables are available in 3, 5, or 10 lead configurations. The reusable shielded TruLink lead wires feature individual color-coded leads with a 2-prong connection into the monitor cable. They are available in a variety of lengths with either a snap or pinch electrode interface. For use with Spacelabs command modules 90496/91496.

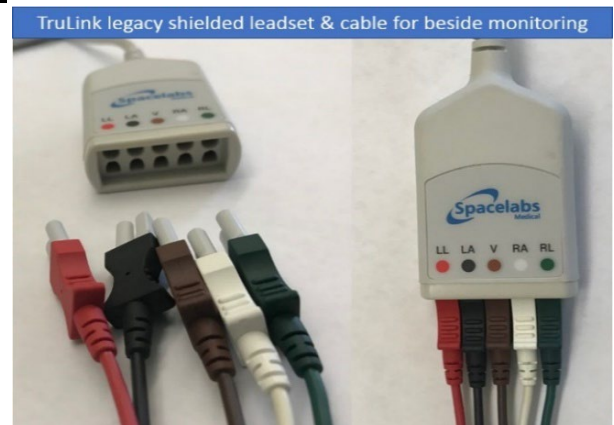

Order Code Description Length/Size Qty

ECG Lead Wire Sets, Shielded, Reusable, AAMI



Snap

Snap Sets

700-0007-00	3 Lead, Shielded	61 cm/24 in	1 Set
700-0007-02	3 Lead, Shielded	102 cm/40 in	1 Set
700-0007-08	5 Lead, Shielded	61 cm/24 in	1 Set
700-0007-10	5 Lead, Shielded	102 cm/40 in	1 Set
700-0007-16	10 Lead, limb/chest, Shielded	61 cm/24 in	1 Set
700-0007-18	10 Lead, limb/chest, Shielded	102 cm/40 in	1 Set



Pinch

Pinch Sets

700-0006-00	3 Lead, Shielded	61 cm/24 in	1 Set
700-0006-02	3 Lead, Shielded	102 cm/40 in	1 Set
700-0006-08	5 Lead, Shielded	61 cm/24 in	1 Set
700-0006-10	5 Lead, Shielded	102 cm/40 in	1 Set
700-0006-16	10 Lead, limb/chest, Shielded	61 cm/24 in	1 Set

ECG Lead Wires, Individual Colors, Shielded, Reusable, AAMI



24" Snap Individual Color

012-0498-00	Red	61 cm/24 in	3/Pack
012-0498-04	Black	61 cm/24 in	3/Pack
012-0498-05	Brown	61 cm/24 in	3/Pack
012-0498-03	White	61 cm/24 in	3/Pack
012-0498-01	Green	61 cm/24 in	3/Pack
012-0498-06	Red	102 cm/40 in	3/Pack
012-0498-09	Black	102 cm/40 in	3/Pack
012-0498-27	Brown	102 cm/40 in	3/Pack
012-0498-08	White	102 cm/40 in	3/Pack
012-0498-07	Green	102 cm/40 in	3/Pack

ECG Lead Wire & Cables - Shielded

TruLink ECG lead wires are designed and validated for use with Spacelabs monitoring systems. Ten foot reusable monitor cables are available in 3, 5, or 10 lead configurations. The reusable shielded TruLink lead wires feature individual color-coded leads with a 2-prong connection into the monitor cable. They are available in a variety of lengths with either a snap or pinch electrode interface. For use with Spacelabs command modules 90496/91496.

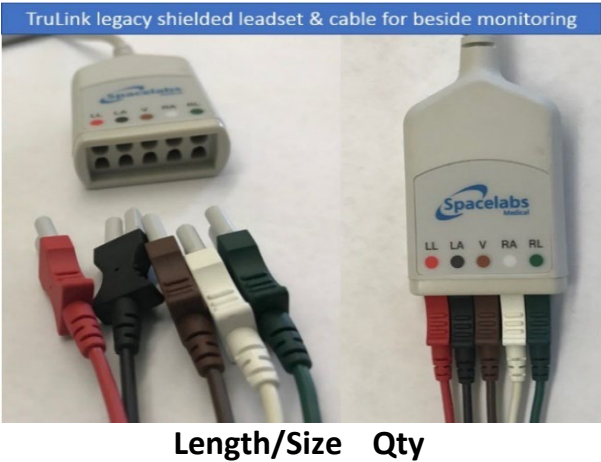

Order Code	Description	Length/Size	Qty
------------	-------------	-------------	-----

ECG Cables, Shielded, AAMI



Spacelabs Connect Hardwired Cables for use with Spacelabs command module 90496/91496

700-0008-08	3 Lead, Shielded	305 cm/10 ft	1 Cable
700-0008-06	5 Lead, Shielded	305 cm/10 ft	1 Cable
700-0008-00	10 Lead, Shielded	305 cm/10 ft	1 Cable

Neonatal ECG Supplies & Accessories



DIN Unshielded, Neonatal ECG Cable

700-0008-12	3 Lead	Neonatal	1 Cable
-------------	--------	----------	---------

DIN Unshielded, Neonatal Electrodes.

717-0080-00	Pre-wired neonatal electrodes, Pre-gelled, silver/silver chloride, single use <i>24 month shelf life from date of manufacture</i>	3-Lead	100 Sets/Box
-------------	--	--------	-----------------

DIN Unshielded Leadwire & Telemetry

TruLink ECG Din unshielded reusable lead wires are available in 3 and 5-lead sets. They can be ordered with a snap or pinch electrode interface. A grouper adapter is also available to help manage leads for a quick connection to the transmitter. Validated for use with models 90341, 90343, 90347, 91341, 91343, 91347 and 96281.

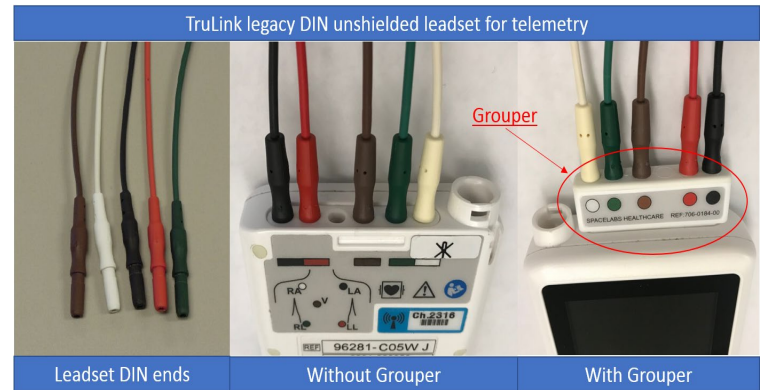

Order Code	Description	Length/Size	Qty
------------	-------------	-------------	-----

ECG Lead Wire Sets, DIN Unshielded, Reusable, AAMI



Snap Sets

015-0732-00	3 Lead	90 cm/35 in	1 Set
015-0736-00	5 Lead	90 cm/35 in	1 Set



Pinch Sets

015-0731-00	3 Lead	90 cm/35 in	1 Set
012-0284-11	3 Lead	61 cm/24 in	1 set
015-0734-00	5 Lead	90 cm/35 in	1 Set

Indicates discontinued part, available while supplies last

Telemetry Transmitter Adapters



For use with DIN Unshielded Lead Wires

706-0191-00	Aria Telemetry Grouper (96281)	5/Bag
-------------	--------------------------------	-------

DIN Unshielded Leadwire & Telemetry

TruLink ECG Din unshielded reusable lead wires are available in 3 and 5-lead sets. They can be ordered with a snap or pinch electrode interface. A grouper adapter is also available to help manage leads for a quick connection to the transmitter. Validated for use with models 90341, 90343, 90347, 91341, 91343, 91347 and 96281.

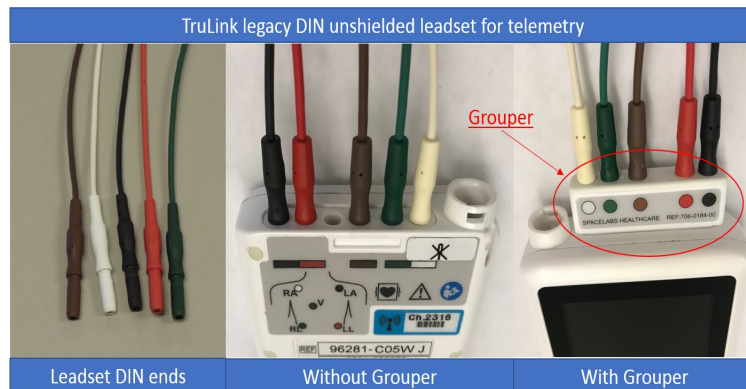

Order Code	Description	Length/Size	Qty
------------	-------------	-------------	-----

Telemetry Accessories



Protective Solutions and Electrodes

010-2350-00	Aria Tele Bumper	5/Box
015-0500-02	Ultraview Telemetry pouch (90347)	100/Box



DIN Unshielded Leadwire & Telemetry

TruLink ECG Din unshielded reusable lead wires are available in 3 and 5-lead sets. They can be ordered with a snap or pinch electrode interface. A grouper adapter is also available to help manage leads for a quick connection to the transmitter. Validated for use with models 90341, 90343, 90347, 91341, 91343, 91347 and 96281.



Order Code	Description	Length/Size	Qty
------------	-------------	-------------	-----

SpO₂ Cable & Sensors

Note: Only the below genuine Spacelabs and Nellcor branded SpO₂ sensors are compatible with Spacelabs Telemetry systems

SpO₂ Cable



700-0014-00	TruLink SpO2 Sensor Adapter Cable Compatible with SL multi-parameter telemetry transmitters (90343/91343/96281) and TruLink SpO2 sensors	60 cm/24 in	1 Cable
-------------	--	-------------	---------

Reusable SpO₂ Sensors



015-0660-00	TruLink SpO ₂ finger sensor	Adult >30 kg/66 lbs.	1 Each
-------------	--	-------------------------	--------



690-0003-01	Nellcor DS-100A, finger SpO2 sensor <i>Available for sale with monitor purchase</i>	Adult >30 kg/66 lbs.	1 Each
-------------	--	-------------------------	--------

Disposable SpO₂ Sensors



015-0662-00	TruLink SpO ₂ foam sensor	Adult > 30 kg/66 lbs.	24/Box
-------------	--------------------------------------	--------------------------	--------



015-0663-00	TruLink SpO ₂ vinyl sensor	Adult >30 kg/66 lbs.	24/Box
-------------	---------------------------------------	-------------------------	--------



015-0664-00	TruLink SpO ₂ foam sensor	Pediatric 10-50 kg/ 22-110 lbs.	24/Box
-------------	--------------------------------------	---------------------------------------	--------



015-0665-00	TruLink SpO ₂ vinyl sensor	Pediatric 10-50 kg/ 22-110 lbs.	24/Box
-------------	---------------------------------------	---------------------------------------	--------



015-0667-00	TruLink SpO ₂ cloth sensor	Neonatal <3 kg/7 lbs.	24/Box
-------------	---------------------------------------	--------------------------	--------

Indicates discontinued part, available while supplies last