

Electrocardiography

IEC COLOR CODING



ECG Combiner Lead Wires & Cables

Our ECG Combiner System of lead wires, cables and adapters allows you to standardize ECG supplies across monitoring brands. The system features a universal connection between cables and lead wires which allows a quick connect/disconnect between monitors and telemetry, and single patient multiple use lead wire options. System is validated for use with Spacelabs command modules 90496/91496 and Aria/Ultraview Telemetry.

ECG COMBINER LEAD WIRE SYSTEM IEC Color Coded

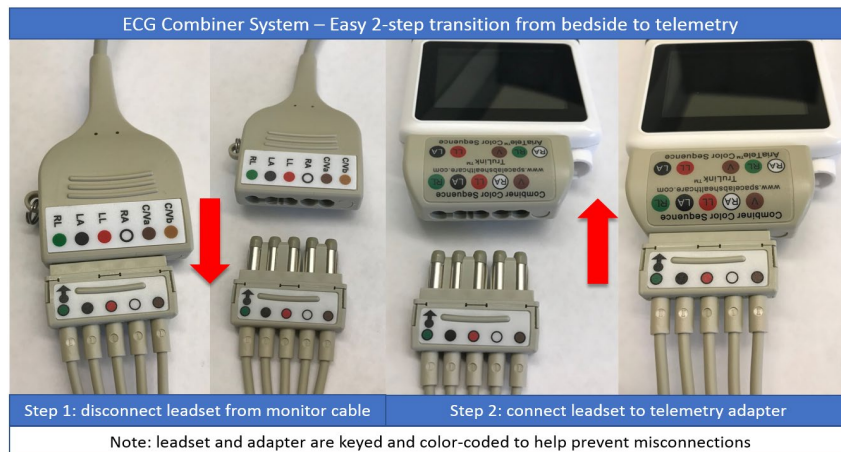

Order Code	Description	Length	Qty
------------	-------------	--------	-----

ECG Combiner Lead Wire Sets - requires ECG Combiner Cable or Adapter



Multi-pinch

Reusable, DIN Shielded, Multi-Pinch, IEC

700-0010-02	5 Lead (V-Lead)	Multi-Pinch	130cm/51 in	1 Set
700-0006-43	5 Lead	Multi-Pinch	74 cm /29 in	1 Set
700-0006-44	5 Lead	Multi-Pinch	127cm /50 in	1 Set



Snap

Reusable, DIN Shielded, Snap, IEC

700-0007-41	3 Lead	Snap	74cm /29 in	1 Set
-------------	--------	------	-------------	-------

Indicates discontinued part, available while supplies last

ECG Combiner Cables



Spacelabs Connect Hardwired Cables for monitors using Command Module (90496/91496)





700-0008-81	3 Lead	IEC	305 cm/10 ft	1 Cable
700-0008-83	5 Lead	IEC	305 cm/10 ft	1 Cable
700-0008-84	10 Lead	IEC	305 cm/10 ft	1 Cable

ECG LEAD WIRES & CABLES IEC Color Coded - Shielded

ECG Lead Wires & Cables - Shielded

IEC color coded shielded ECG lead wires and cables for use with Spacelabs Command Modules 90496 & 91496 and mCare Monitor 91220.





	Order Code	Description	Length	Qty
ECG Lead Wire Sets, Shielded, Reusable, IEC				
 Snap	Snap Sets			
	700-0007-01	3 Lead, shielded	61 cm/24 in	1 Set
	700-0007-03	3 Lead, shielded	102 cm/40 in	1 Set
	700-0007-09	5 Lead, shielded	61 cm/24 in	1 Set
	700-0007-11	5 Lead, shielded	102 cm/40 in	1 Set
	700-0007-17	10 Lead, limb/chest, shielded	61 cm/24 in	1 Set
	700-0007-19	10 Lead, limb/chest, shielded	102 cm/40 in	1 Set
 Pinch	Pinch Sets			
	700-0006-01	3 Lead, shielded	61 cm/24 in	1 Set
	700-0006-03	3 Lead, shielded	102 cm/40 in	1 Set
	700-0006-09	5 Lead, shielded	61 cm/24 in	1 Set
	700-0006-11	5 Lead, shielded	102 cm/40 in	1 Set
	700-0006-17	10 Lead, limb/chest, shielded	61 cm/24 in	1 Set
	700-0006-19	10 Lead, limb/chest, shielded	102 cm/40 in	1 Set
ECG Cables, Shielded, IEC				
	Spacelabs Connect Hardwired Cables for use with Spacelabs command module 90496/91496			
	700-0008-09	3 Lead, shielded	305 cm/10 ft	1 Cable
	700-0008-07	5 Lead, shielded	305 cm/10 ft	1 Cable
	700-0008-01	10 Lead, shielded	305 cm/10 ft	1 Cable
<i>Indicates discontinued part, available while supplies last</i>				
ECG Accessories				
	Electrodes			
	717-0083-00	Electrode, Transparent Tape, 5 per pouch X 10 Pouches <i>24 month shelf life from date of manufacture</i>	Adult	50/Box

ECG LEAD WIRES & CABLES IEC Color Coded - Shielded

ECG Lead Wires & Cables - Shielded

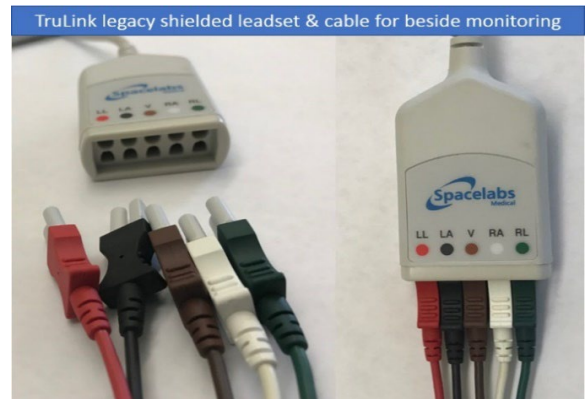
IEC color coded shielded ECG lead wires and cables for use with Spacelabs Command Modules 90496 & 91496 and mCare Monitor 91220.



Order Code	Description	Length	Qty
Neonatal ECG Supplies & Accessories			
	DIN Unshielded, Neonatal ECG Cable		
700-0008-13	3 Lead		1 Cable
	DIN Unshielded, Neonatal Electrodes		
717-0080-00	Pre-wired neonatal electrodes, pre-gelled, silver/silver chloride, CE <i>24 month shelf life from date of manufacture</i>	3-Lead	100 Sets/Box

DIN Unshielded Lead Wires & Telemetry

TruLink ECG Din unshielded reusable lead wires are validated for use with Spacelabs telemetry systems. They are available in 3 and 5-lead sets, or available to purchase individually in color-coded multi-packs. They can be ordered with a snap or pinch electrode interface. A grouper adapter is also available to help manage leads for a quick connection to the transmitter. Validated for use with models 90341, 90343, 90347, 91341, 91343, 91347 and 96281.

ECG LEAD WIRES & TELEMETRY IEC Color Coded - DIN Unshielded

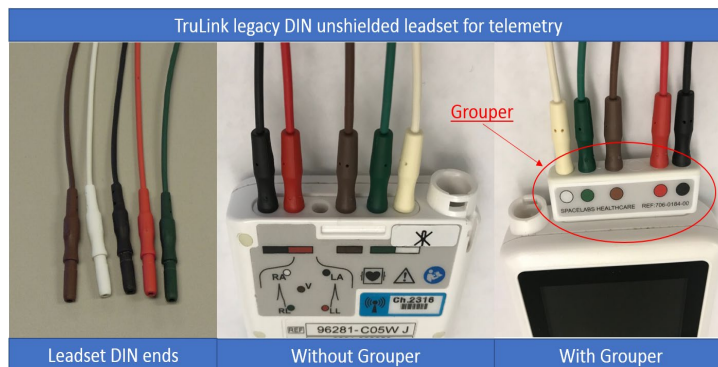

Order Code	Description	Length/Size	Qty
------------	-------------	-------------	-----

ECG Lead Wire Sets, DIN Unshielded, Reusable, IEC



Snap

Snap Sets

015-0733-00	3 Lead	90 cm/35 in	1 Set
012-0328-10	5 Lead	61 cm/24 in	1 Set
015-0737-00	5 Lead	90 cm/35 in	1 Set



Pinch Sets

015-0735-00	5 Lead	90 cm/35 in	1 Set
-------------	--------	-------------	-------

For use with DIN Unshielded Lead Wires

706-0190-00	Aria Telemetry Grouper (96281), IEC		5/Bag
-------------	-------------------------------------	--	-------

Telemetry Accessories



Disposable Pouches and Electrodes

010-2350-00	Aria Tele Bumper		5/box
015-0500-02	Ultraview Telemetry pouch (90347)		100/Box
717-0083-00	Electrode, Transparent Tape, 5 per pouch X 10 Pouches <i>24 month shelf life from date of manufacture</i>	Adult	50/Box

Bold font indicates a new part number

Indicates discontinued part, available while supplies last

DIN Unshielded Lead Wires & Telemetry

TruLink ECG Din unshielded reusable lead wires are validated for use with Spacelabs telemetry systems. They are available in 3 and 5-lead sets, or available to purchase individually in color-coded multi-packs. They can be ordered with a snap or pinch electrode interface. A grouper adapter is also available to help manage leads for a quick connection to the transmitter. Validated for use with models 90341, 90343, 90347, 91341, 91343, 91347 and 96281.

ECG LEAD WIRES & TELEMETRY IEC Color Coded - DIN Unshielded

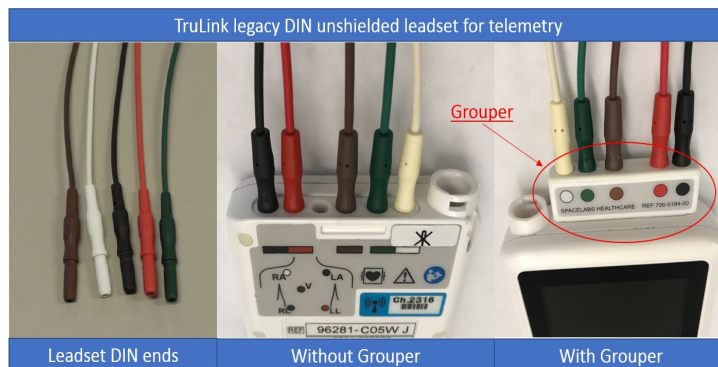

Order Code	Description	Length/Size	Qty
------------	-------------	-------------	-----

SpO₂ Cable & Sensors

SpO₂ Cable



700-0014-00	TruLink SpO2 Sensor Adapter Cable Compatible with SL multi-parameter telemetry transmitters (90343/91343/96281) and TruLink SpO2 sensors	60 cm/24 in	1 Cable
-------------	--	-------------	---------

Note: Only the below genuine Spacelabs and Nellcor branded SpO₂ sensors are compatible with Spacelabs Telemetry systems

Reusable SpO₂ Sensors



015-0660-00	TruLink SpO ₂ finger sensor	Adult >30 kg/66 lbs.	1 Each
-------------	--	-------------------------	--------



690-0003-01	Nellcor DS-100A, finger SpO2 sensor <i>Available for sale with monitor purchase</i>	Adult >30 kg/66 lbs.	1 Each
-------------	--	-------------------------	--------

Disposable SpO₂ Sensors



015-0662-00	TruLink SpO ₂ foam sensor	Adult > 30 kg/66 lbs.	24/Box
-------------	--------------------------------------	--------------------------	--------



015-0663-00	TruLink SpO ₂ vinyl sensor	Adult >30 kg/66 lbs.	24/Box
-------------	---------------------------------------	-------------------------	--------



015-0664-00	TruLink SpO ₂ foam sensor	Pediatric 10-50 kg/ 22-110 lbs.	24/Box
-------------	--------------------------------------	---------------------------------------	--------



015-0665-00	TruLink SpO ₂ vinyl sensor	Pediatric 10-50 kg/ 22-110 lbs.	24/Box
-------------	---------------------------------------	---------------------------------------	--------



015-0667-00	TruLink SpO ₂ cloth sensor	Neonatal <3 kg/7 lbs.	24/Box
-------------	---------------------------------------	--------------------------	--------

Indicates discontinued part, available while supplies last